

205/54 Nannine Place Rivervale WA

2 1 1

Functional & Contemporary Top Floor Apartment at "Riverlux Villas"

Fantastic opportunity to secure this light & bright 2 Bedroom 1 Bathroom apartment, second floor benefiting from its elevated views - balcony in a secure complex, end Cul-de-sac street.

Enjoy the location and proximity to all Perth City Highlights. With the picturesque Swan River next to you, you would love morning walks, the local Cafes-Restaurants, nearby shops and connectivity to the Crown Casino, Optus Stadium, Airports and of course all the abundance of public transport and easy access to main roads and Perth CBD.

With a practical open floor plan configuration, renovated and bright layout this residence is available now.

Building Size : 60 sqm
Land Size : 56 sqm
View : <https://www.lauriekelly.com.au/sale/wa/eastern-suburbs/rivervale/residential/unit/7940762>



Franklin Martinez
 08 9277 4200

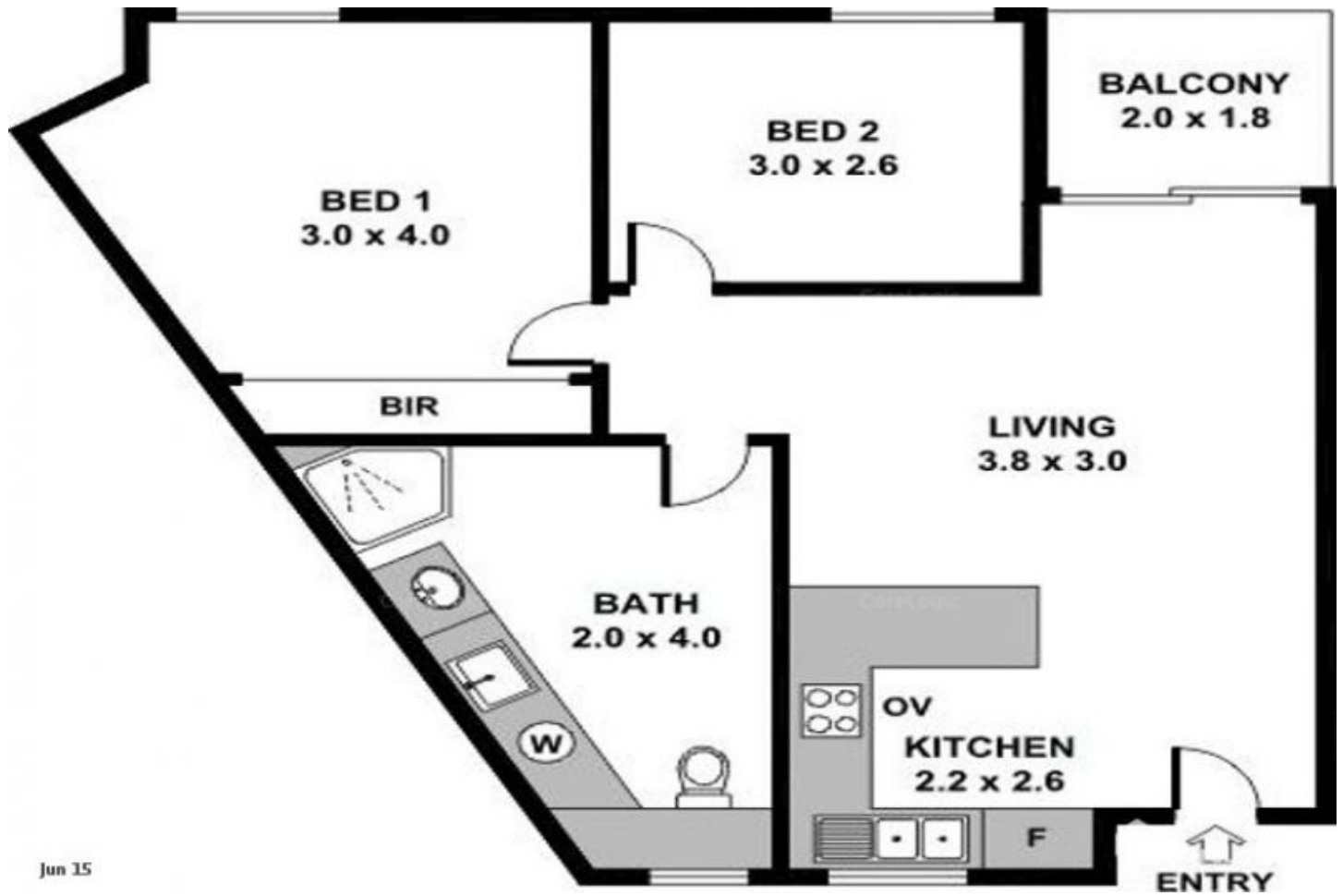

Jun 15