



**187 Gabriel Street Cloverdale WA**

4 1 6

(GENUINE ONE OWNER AUSTRALIANA CLASSIC)

First homebuyers & investors this sensational one owner four bed brick & zinc home in central Belmont City location has never been sold. Boasting a sprawling manicured 625sqm bore/retic block that is beautifully presented and just perfect for garden lovers and buyers with young children. Sensibly priced to sell quickly this classic Australiana character home and is ready to move in to and enjoy right now!

**Type** : House  
**Building Size** : 104 sqm  
**Land Size** : 625 sqm  
**View** : <https://www.lauriekelly.com.au/sale/wa/southern-suburbs/cloverdale/residential/house/8083118>

"RED HOT" FEATURES INCLUDE:

- \*Rectangular shaped 625sqm block zoned R20/40
- \*Timeless brick construction/ modern zinc roof

[For full version visit the website](https://www.lauriekelly.com.au)



**Devon Kelly**  
 08 9277 4200

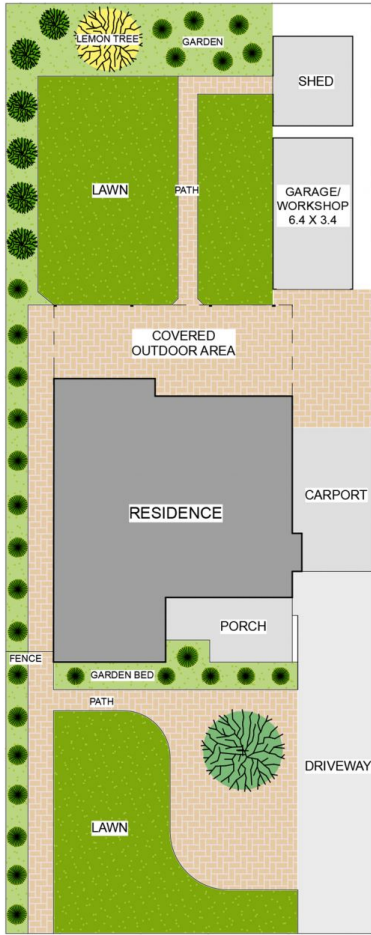

SITE PLAN



GROUND FLOOR PLAN



MAIN HOUSE AREA = 104m<sup>2</sup>  
 COVERED OUTDOOR AREA = 49m<sup>2</sup>  
 GARAGE/WORKSHOP AREA = 22m<sup>2</sup>  
 CARPORT AREA = 20m<sup>2</sup>

**TOTAL = 195m<sup>2</sup>**

**BLOCK = 625m<sup>2</sup>**

## 187 Gabriel Street, Cloverdale

PLAN IS APPROXIMATE AND REPRESENTATIONAL ONLY