



95 Hardey Road Belmont WA

3 1 8

(EOI BY 17/3 - UNLESS SOLD PRIOR)

Scoop up this renovated three-bedroom double brick / tile home in perfect condition opposite the picturesque Centenary Park in central Belmont location. The sprawling 776sqm block is zoned R20/40 with an extra wide 24.14mt frontage perfect for development with heaps of options available. The property is currently leased to a model tenant till the 1st May 2025 who would love to stay if possible but the choice will be yours. Whether you are looking for a future develop site or just a great home to invest in and raise a family, this gem ticks all the boxes.

Type : House
Price : MR BELMONT - UNDER OFFER!
Land Size : 776 sqm
View : <https://www.lauriekelly.com.au/sale/wa/east-ern-suburbs/belmont/residential/house/8270241>

KEY FEATURES INCLUDE

[For full version visit the website](#)



Devon Kelly
 08 9277 4200

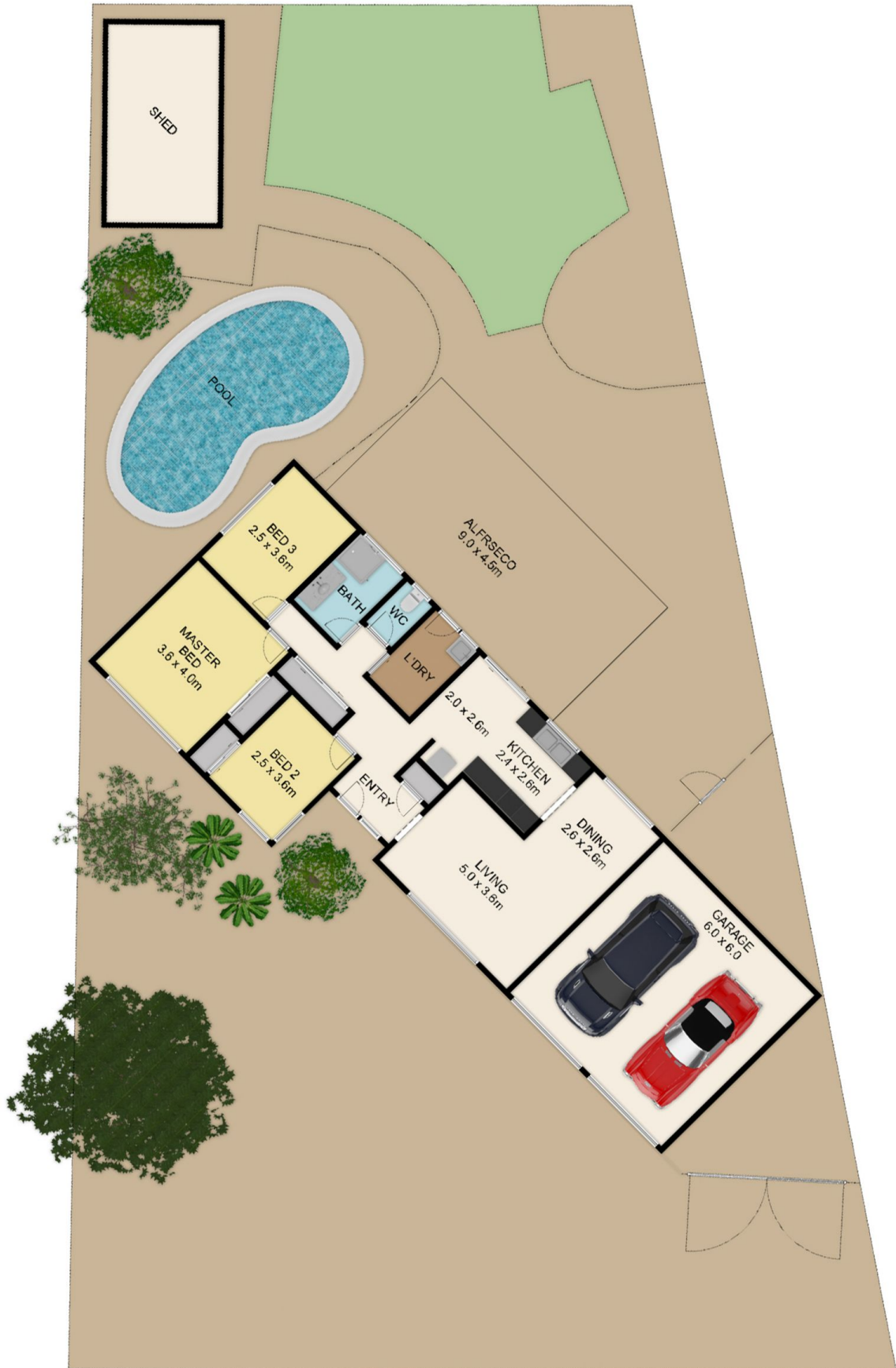

95 Hardey Road, Belmont

This floor plan is not to scale.
Dimensions are approximate and therefore should only be used for illustrative purposes.

| | |
|---|-------------------|
|  | 776m ² |
|  | 3 Bed |
|  | 1 Bath |
|  | 2 Car |