



LATHLAIN

4 2 2

Coming Soon - This Residential Attitudes built home, in conjunction with Intelligent Homes, will absolutely BLOW YOUR MIND.

With an unrivalled attention to detail and an unsurpassed designer look & feel, Christmas has just come early!

My seller built this home for happily ever after, but with retirement imminent, it has been decided that it's time to pass this perfect property onto the next family... perhaps yours?

Features include, but are not limited to:

- Front security gate (with video intercom) that leads to an office (or gym) with its own entrance, perfect for the home business operator

[For full version visit the website](#)

Type : House
Building Size : 23 sqm
Land Size : 512 sqm
View : <https://www.lauriekelly.com.au/sale/wa/southern-suburbs/lathlain/residential/house/8368023>

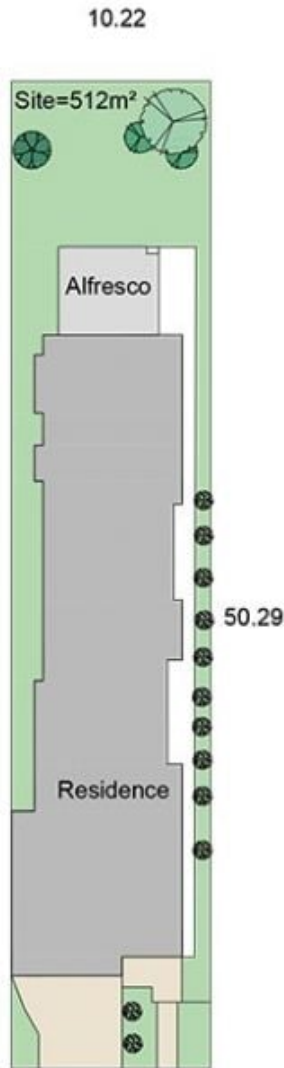

Howick Street

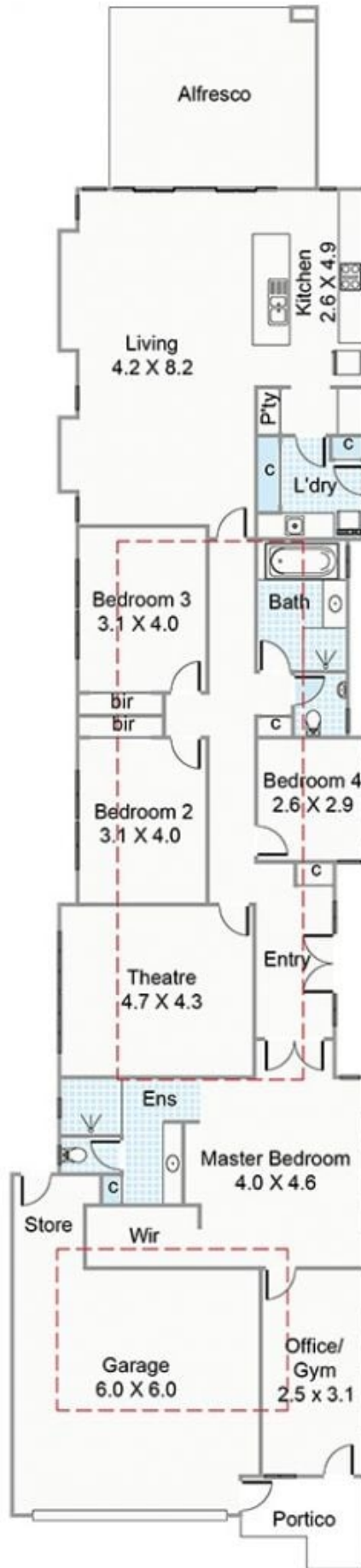

Legend:



Approximate Areas

GROUND FLOOR

Residence: 212.99m²

Garage/Store: 41.70m²

Alfresco: 22.91m²

Total Area: 277.60m²

All measurements are estimates
All dimensions are in metres.
Plans are for demonstration only.
www.cribcreative.com.au



88A Howick Street, Lathlain